

READ ALL INSTRUCTIONS CAREFULLY BEFORE PROCEEDING

EXHAUST PORT FILTERS (2) INCLUDED REPLACEMENT PART NO. 030092

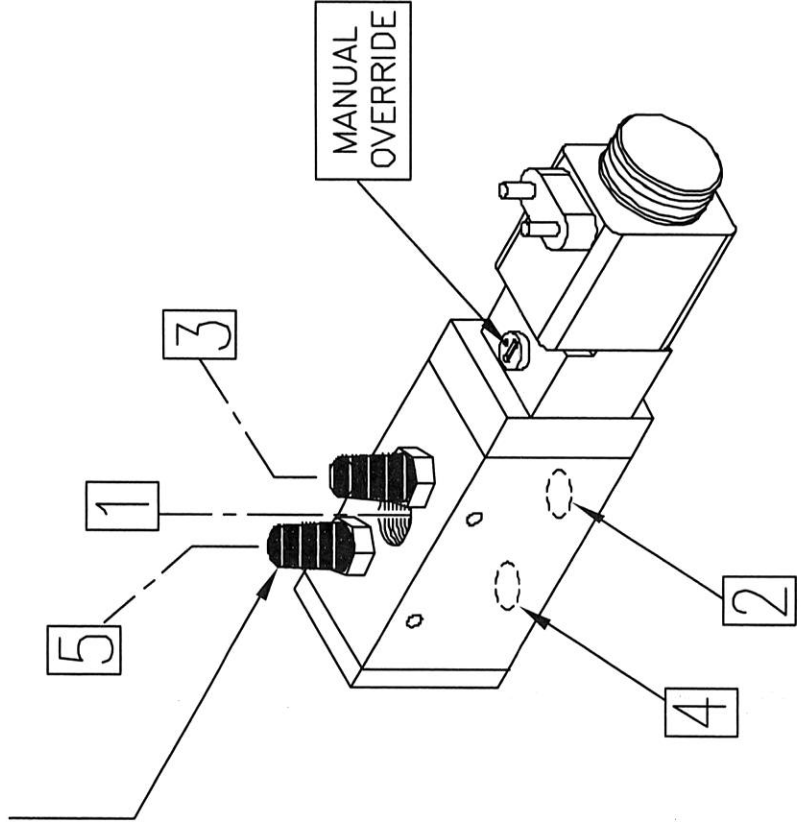

IMPORTANT NOTE

- IT IS IMPORTANT THAT THE AIR SUPPLY IS CLEAN. FOR MAXIMUM VALVE LIFE IT IS RECOMMENDED THAT THE AIR SUPPLY BE RUN THROUGH A FILTER LUBRICATOR SYSTEM.
- ALWAYS USE EXHAUST FILTERS AS SHOWN. FILTERS MAY BE ORDERED SEPARATELY.
- DO NOT PAINT VALVE AFTER INSTALLATION.
- DO NOT USE TEFLON TAPE TO SEAL VALVE PORT FITTINGS. A LIQUID OR PASTE SEALER IS RECOMMENDED.
- 12 VOLT DC ONLY

OPERATING PRESSURE
35-150 PSI

VALVE OPERATION (OFF POSITION)		
PORT	OPERATION	PORT SIZE
2	TO CYLINDER (NORMALLY CLOSED)	1/4-18 NPT
4	TO CYLINDER (NORMALLY OPEN)	1/4-18 NPT
1	SUPPLY	1/4-18 NPT
3	EXHAUST (PORT 3)	1/4-18 NPT
5	EXHAUST (PORT 5)	1/4-18 NPT

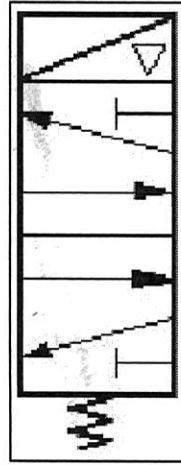

PROPRIETARY

THIS CONCEPT & DRAWING IS THE PROPERTY OF VELVAC, INC. AND SHALL NOT BE REPRODUCED, COPIED, DISCLOSED, USED FOR THE MANUFACTURE OR PROCUREMENT FROM SOURCES OTHER THAN VELVAC INC., WITHOUT WRITTEN PERMISSION FROM VELVAC INC.

SCALE: N/A
DATE: 2-7-03

DRAWN BY: DC

INSTALLATION INSTRUCTIONS FOR 4-WAY SOLENOID VALVES

DRAWING NUMBER:
3201312